

# 1501X Parts List

## S/N 8999 AND BELOW

<u>Figure</u>	<u>Part Number</u>	<u>Description</u>	<u>Qty.</u>
1	W-O001602	1 <sup>st</sup> Fold Table Top	1
2	M-O001638	Non Operator Side Cover	1
3	W-O001616	Paper Stop Locking Bar	2
4	W-O001615	Paper Stop	2
5	M-O001649	Feed Roller Assembly	1
6	W-O001617	Feed Roller Shaft	1
7	M-S018064	1/8 X 5/8 Dowel Pin	1
8	M-S010011	3/8 External "E" Ring	2
9	W-O001606	Extension Table	1
10	M-O001630	Paper Guide	2
11	M-O001636	Right Torsion Spring	1
12	M-S014029	3/8 ID Clip Bearing	2
13	W-I001608	Right Side Frame	1
14	M-S022129	3MM 12T X 5MM ID Pulley	2
15	W-O001613	Feed Deflector	1
16	W-O001614	Separator Frame	1
17	W-A001651	Power Jack Assembly	1
18	W-O001618	Tie Rod	1
19	M-O001647	Plastic Friction Pad	2
20	M-S019032	¼ X 3/8 X .17 ID Spacer	6
21	W-I001605	Feed Table	1
22	M-S005017	Paper Guide Thumbscrew	4
23	W-O001601	1 <sup>st</sup> Fold Table Bottom	1
24	M-S031095	Ext. Spring .19 X 1 X .016	2
25	M-O001635	Left Torsion Spring	1
26	M-S030045	Rubber Foot	4
27	W-O001612	Base Plate	1
28	M-S019033	8-32 X .25 X 1 Standoff	2
29	W-I001607	Left Side Frame	1
30	M-O001624	36T Feed Pulley	1
31	M-S031033	Clutch Spring	1
32	M-S008044	.38 X 1.5 X .06 Flat Washer	1
33	M-S025047	80T 3MM HTD Belt	1
34	M-O001637	Operator Side Cover	1
35	M-S008040	#10 X 1 Fender Washer	1
36	M-O001625	Capstan Bearing	8
37	M-O001632	Roller Tension Spring	2
38	M-S030052	½ Diameter Rubber Bumper	2

<u>Figure</u>	<u>Part Number</u>	<u>Description</u>	<u>Qty.</u>
39	M-S030051	Grommet .25 ID X .44 OD	7
40	W-O001619	Pressure Roller	3
41	W-A001620	Capstan Roller	1
42	W-O001603	2 <sup>nd</sup> Fold Table Bottom	1
43	W-O001611	Exit Tray	1
44	W-O001604	2 <sup>nd</sup> Fold Table Top	1
45	W-A001622	Upper Guide Assembly	1
46	M-S001117	8-32 X 5/8 Truss Head	4
47	M-S033064	On/Off/ Momentary Switch	1
48	M-O001633	Capstan Drive Pulley	1
49	M-S025041	130T 3MM HTD Belt	1
50	M-S045198	24V 1.2A Wall Supply	1
51	W-A001652	DC Motor Assembly	1
52	M-O001643	2 <sup>nd</sup> Fold Table Ruler	2
53	M-O001642	1 <sup>st</sup> Fold Table Ruler	2
54	W-O001641	Guide Load Spring	1
55	M-S032007	Fold Table Thumb Knob	4
56	M-S008045	#10 X 5/16 Fiber Washer	4

S/N 8999 AND BELOW

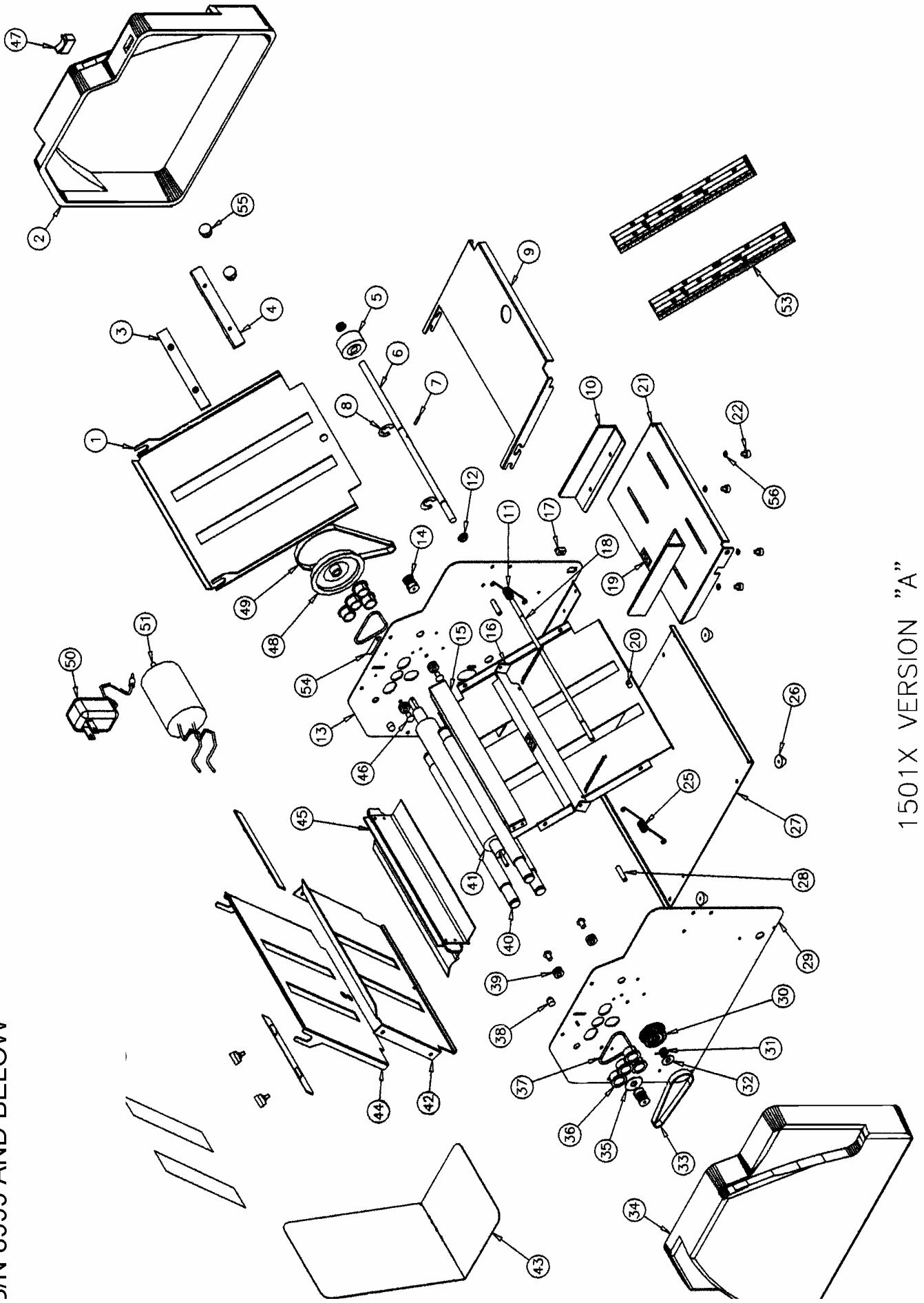

NO. ZONE	REVISIONS	DATE	BY	CHKD BY	CHANGE NO.	APPROVAL	APPROVED DATE

PART LIST		
QTY.	DESCRIPTION	PART No.
1	24 V., 1.2 A. TRXFMR.	M-S045198
1	POWER JACK ASSY.	W-A001651
1	SWITCH ON/OFF/MOM.	M-S033064
1	D.C. MOTOR ASSY.	W-A001652

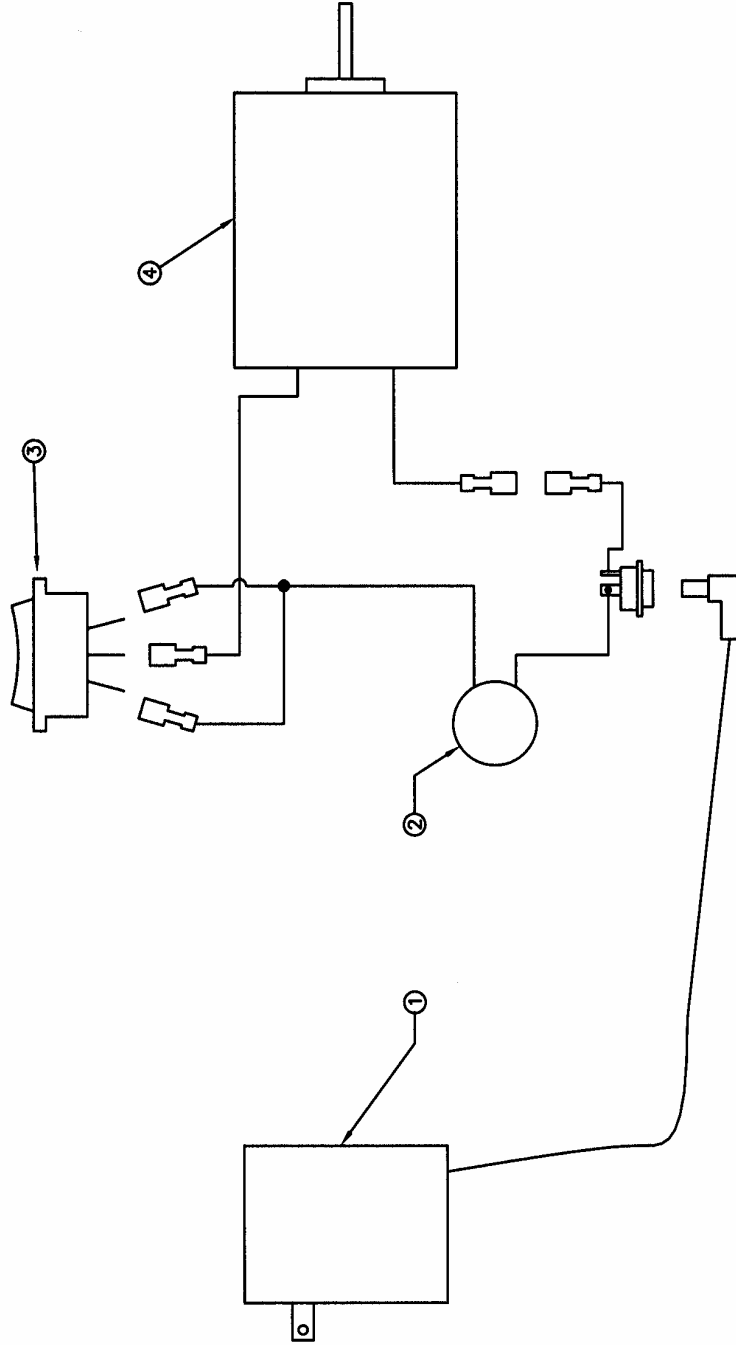

DRAWING SCALE: 100%

**Martin Yale**  
INDUSTRIES, INC.  
251 WEDDOR AVE.  
WABASH, IN 46992  
PHONE (219) 563-0821  
FAX (219) 563-2803

DATE: ARK 10/11/00  
DRAWN BY: [blank]  
CHECKED BY: [blank]  
APPROVED BY: [blank]

NEXT ASSEMBLY: W-A FINAL  
PRODUCT USED ON: P-M P-M1501X0  
CURRENT REVISION: 1  
NO. OF REVISIONS PER INCH: 0

TOLERANCES (unless otherwise noted):  
.XX = ± .010  
.XXX = ± .005  
∠ = ± 1°

SEE PARTS LIST

SIZE: X  
LOCUS: XX  
REV. No.: 0  
SIS FILE No.: (add 000 200)

PART No.: [blank]

5. NO NICKS, SCRATCHES, TOOL MARKS, OR OTHER SURFACE DEFECTS ALLOWED.  
PART IS TO BE FREE OF BURRS AND SHARP EDGES.  
6. SOLDER JOINTS MUST BE FREE OF FLUX AND VOIDS.  
3. COMMERCIAL TOLERANCES AND QUALITY APPLY TO ALL STOCK MATERIALS, SIZES, AND FINISHES.  
2. DIMENSIONS IN INCHES (AND INCLUDE PLATING IF USED).  
1. DO NOT SCALE DRAWING.  
NOTES (IF SPACES)

CV-7 WIRING DIAGRAM