

Mod.4850-95 D

01.08.2009

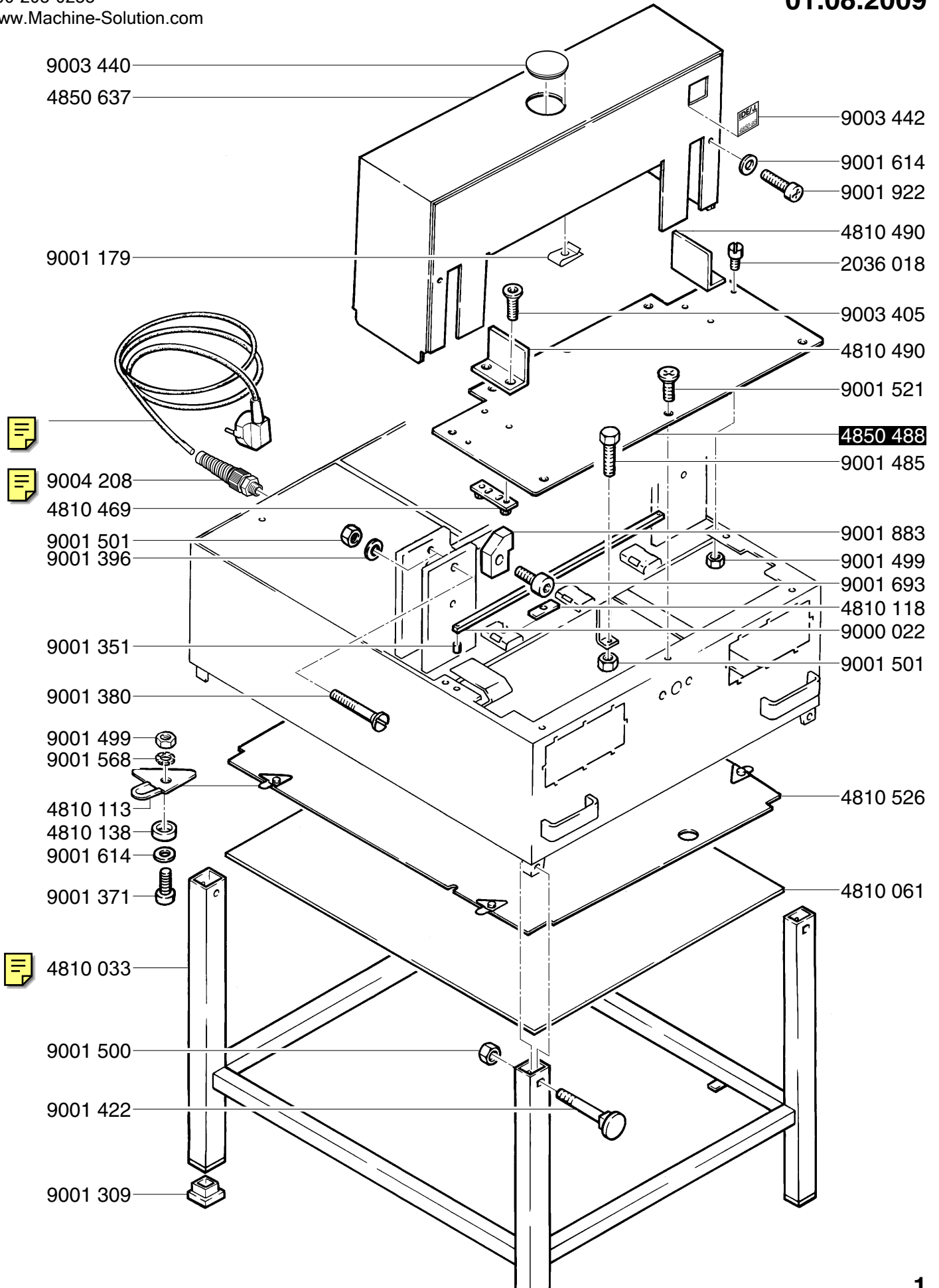

Mod.4850-95 D

01.08.2009

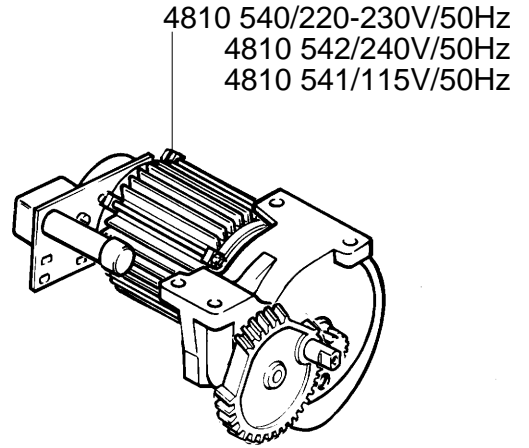
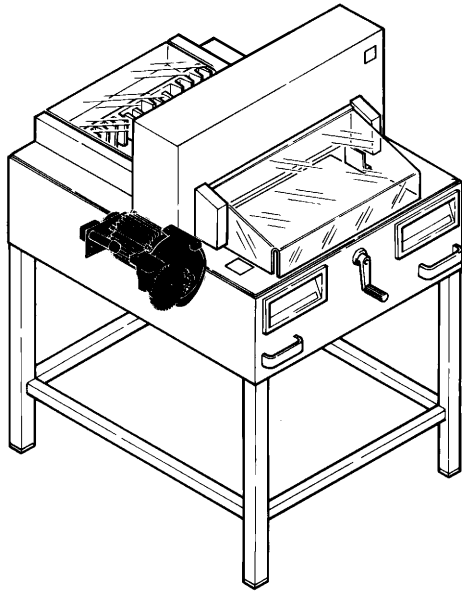

4810 540/220-230V/50Hz
4810 542/240V/50Hz
4810 541/115V/50Hz

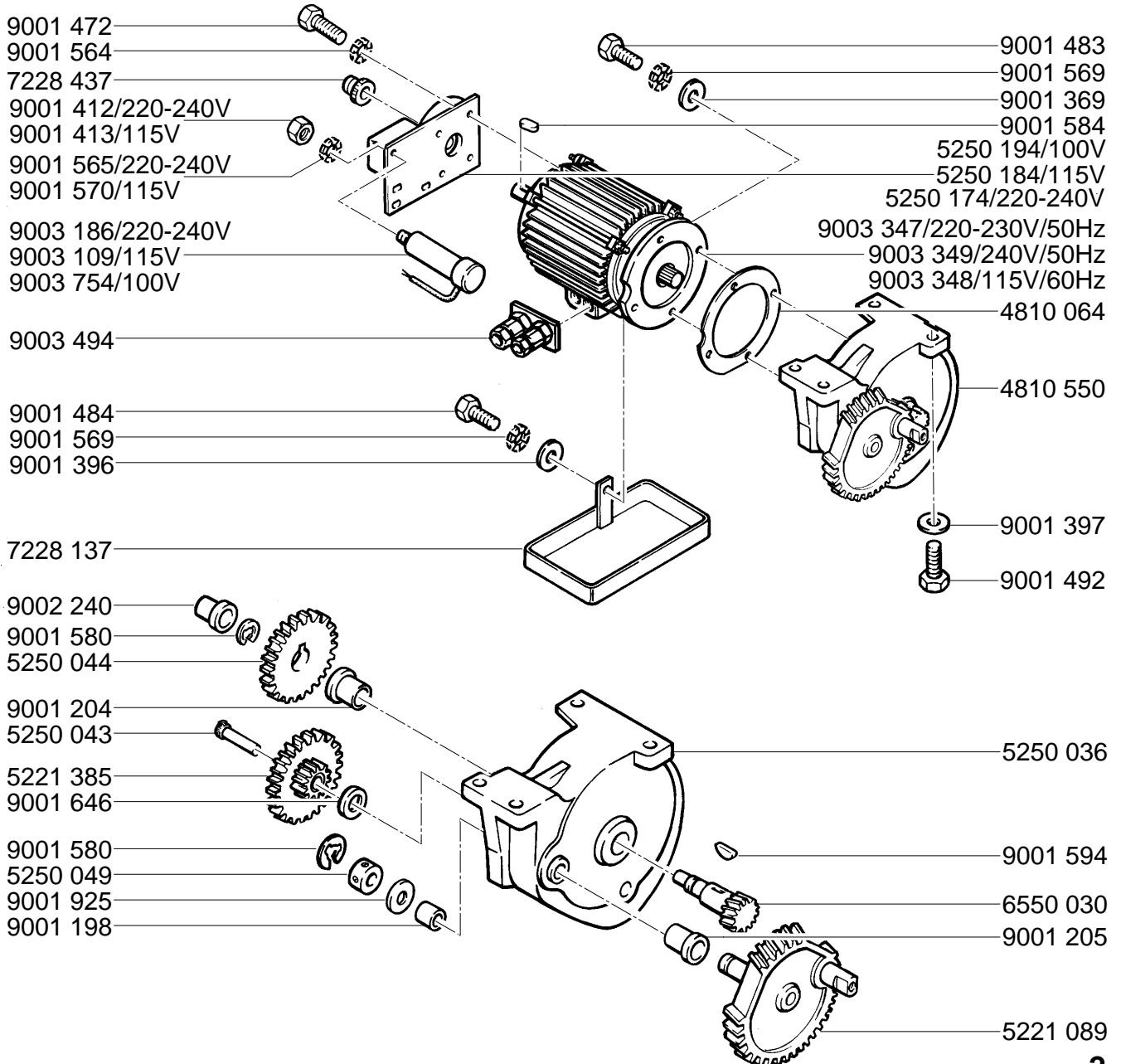

9001 472
9001 564
7228 437
9001 412/220-240V
9001 413/115V
9001 565/220-240V
9001 570/115V
9003 186/220-240V
9003 109/115V
9003 754/100V

9003 494

9001 484
9001 569
9001 396

7228 137

9002 240
9001 580
5250 044

9001 204
5250 043

5221 385
9001 646

9001 580
5250 049
9001 925
9001 198

9001 483
9001 569
9001 369
9001 584
5250 194/100V
5250 184/115V
5250 174/220-240V
9003 347/220-230V/50Hz
9003 349/240V/50Hz
9003 348/115V/60Hz

4810 064

4810 550

9001 397

9001 492

5250 036

9001 594

6550 030

9001 205

5221 089

Mod.4850-95 D

01.08.2009

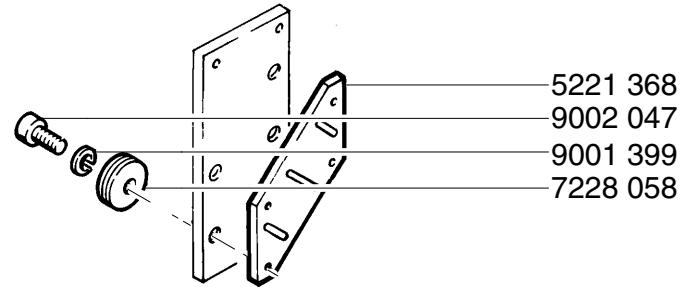
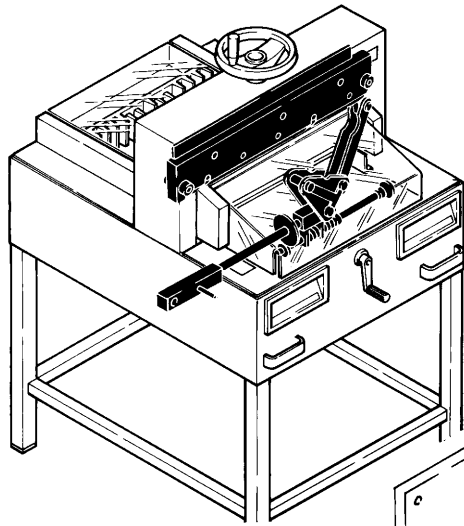

- 9002 047
- 9001 399
- 7228 058
- 5221 368
- 9002 135
- 5221 039
- 9003 001

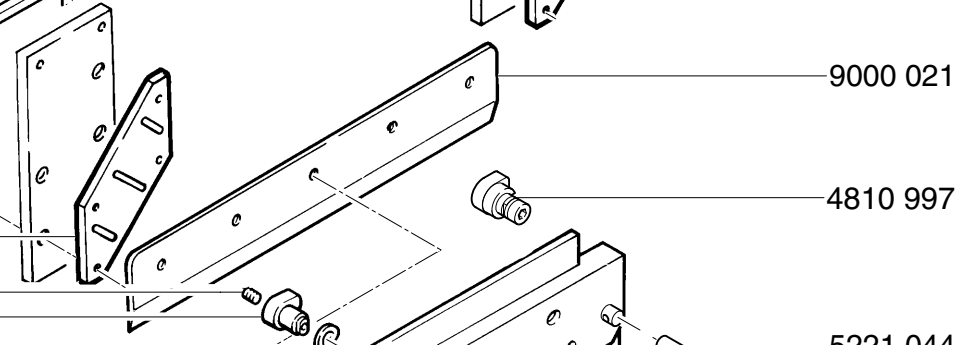

4810 450

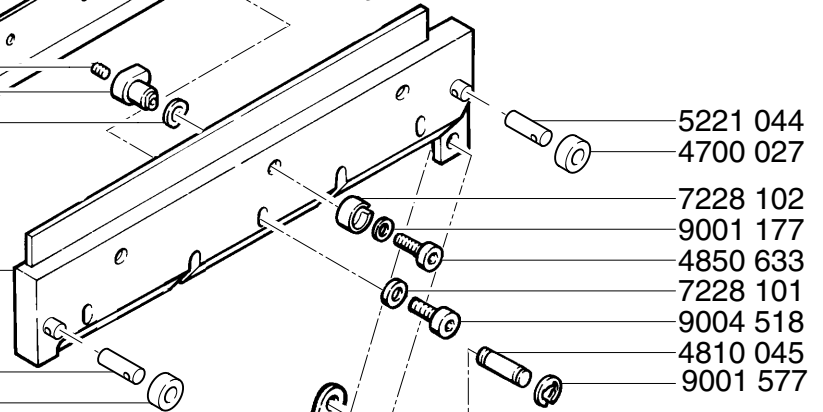

- 5221 044
- 4700 027
- 4810 442

5221 050

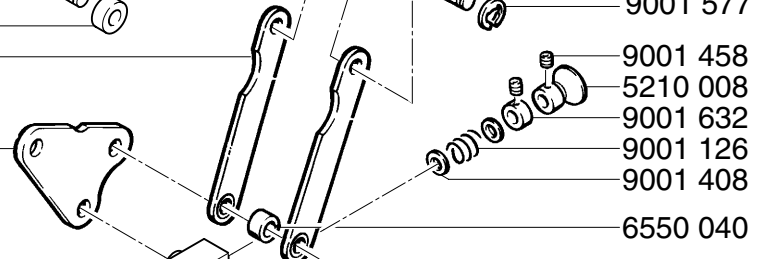

5221 055

4810 035

4810 122

4810 112

4810 037

5221 059

9001 414

9001 564

9001 472

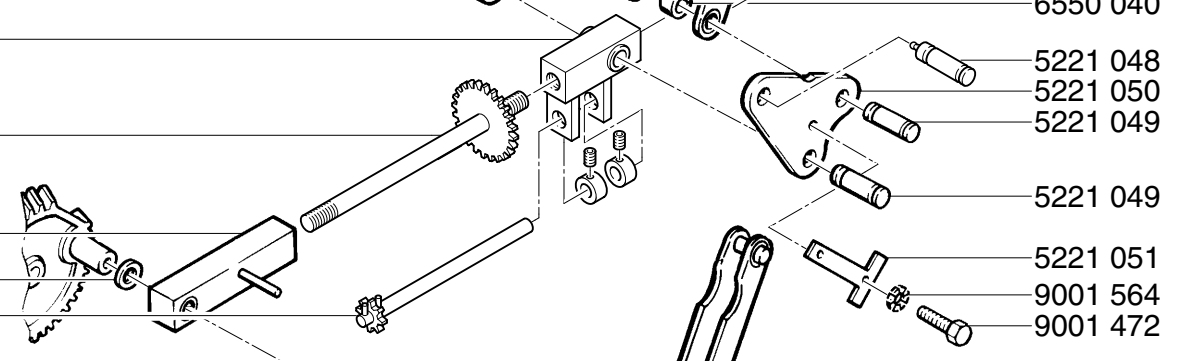

4810 035

4810 468

Mod.4850-95 D

01.08.2009

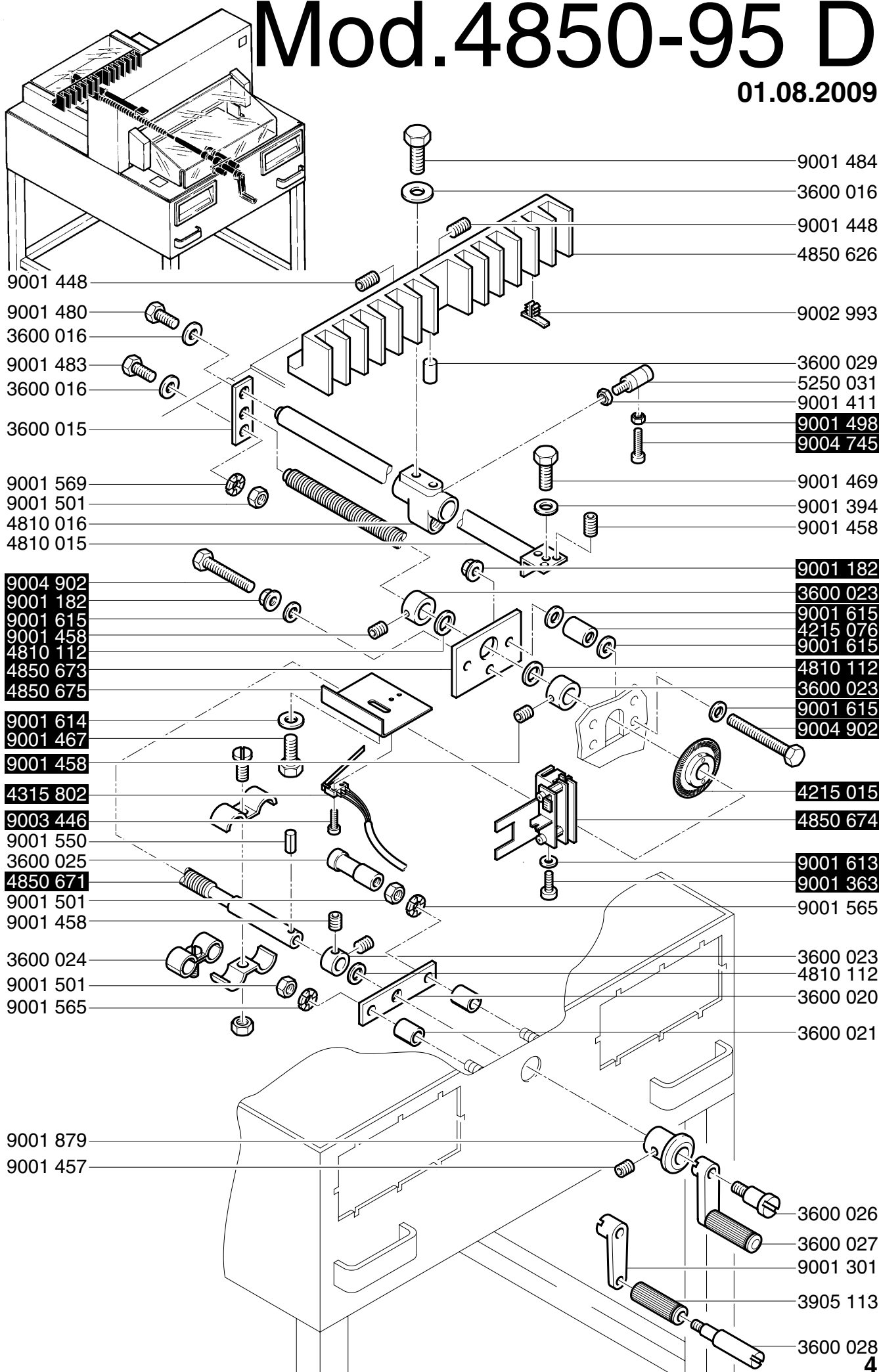

Mod.4850-95 D

01.08.2009

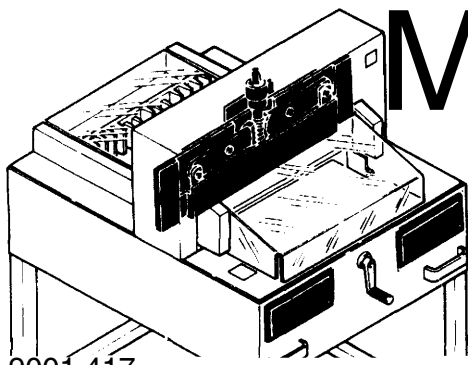

9001 417
4850 702
9800 285

9001 594
9001 136
6550 059
9001 616

9002 240
4850 008
5250 119

9001 614
9001 467
4850 627

9001 485
4202 099
4850 052
4850 628
5221 270

9001 596
9001 485
4202 099
4850 052

9001 480
3600 016
5221 270
4850 592
9001 498
9001 613
9001 498
9001 613

9001 498
9001 393
9005 225

9002 536
9002 282
9001 340
9001 340

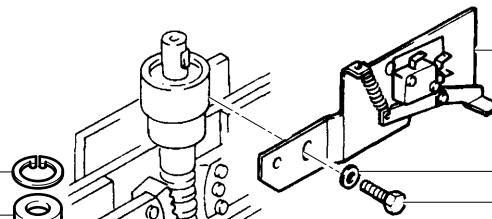

4850 120

9001 216
9001 473

9001 497
9001 562
9001 030
9001 330
9001 358
4850 033
9001 575
4850 087

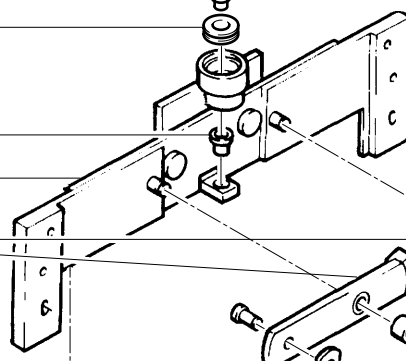

5210 024
5210 025
9001 578
9001 579
9001 196
9001 467
9001 614

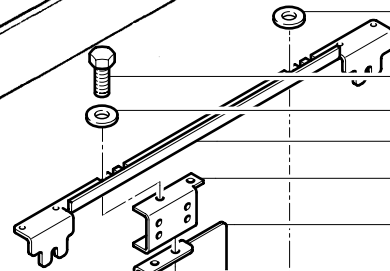

9001 467
9001 614
4850 493
4850 755
4850 757
5010 385
5006 261
9002 696
9004 320

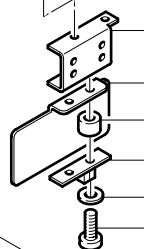

4850 755
4850 756
5010 385
5006 261
9002 696
9004 320

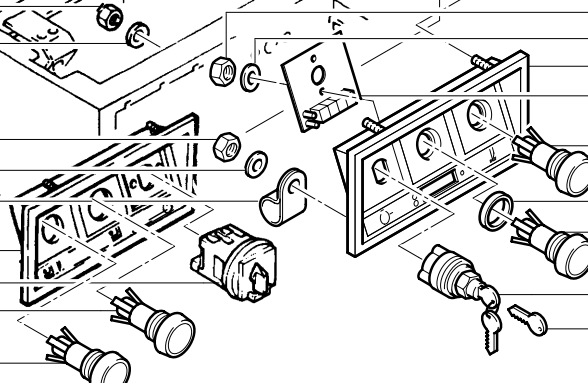

9001 498
9001 393
4850 670
4215 020

9001 340
4850 676
9001 340

9001 345
9001 346

Mod.4850-95 D

01.08.2009

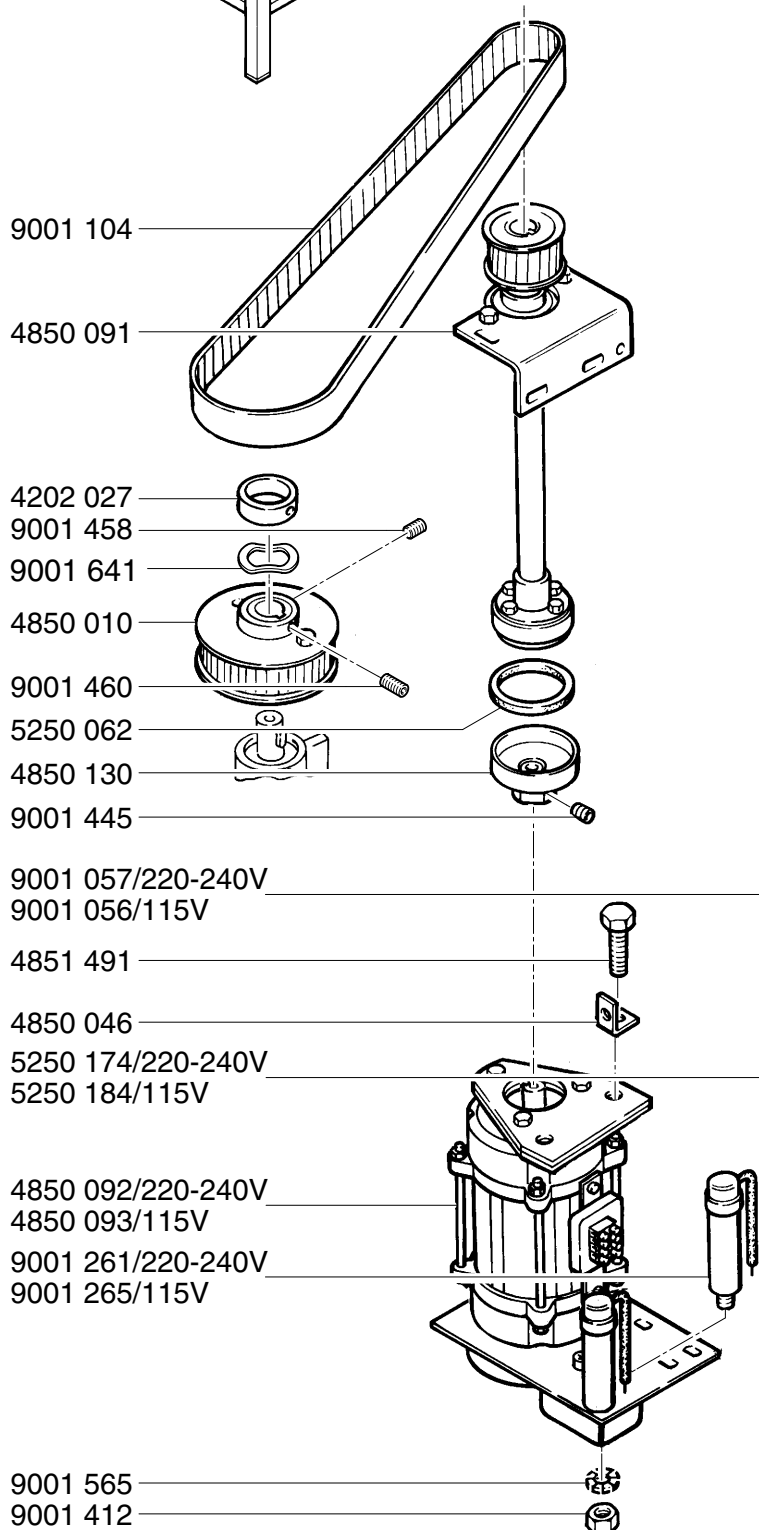
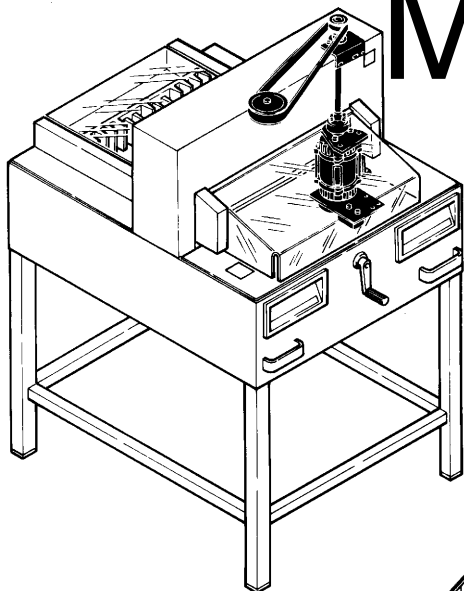

9001 104

4850 091

4202 027

9001 458

9001 641

4850 010

9001 460

5250 062

4850 130

9001 445

9001 057/220-240V

9001 056/115V

4851 491

4850 046

5250 174/220-240V

5250 184/115V

4850 092/220-240V

4850 093/115V

9001 261/220-240V

9001 265/115V

9001 565

9001 412

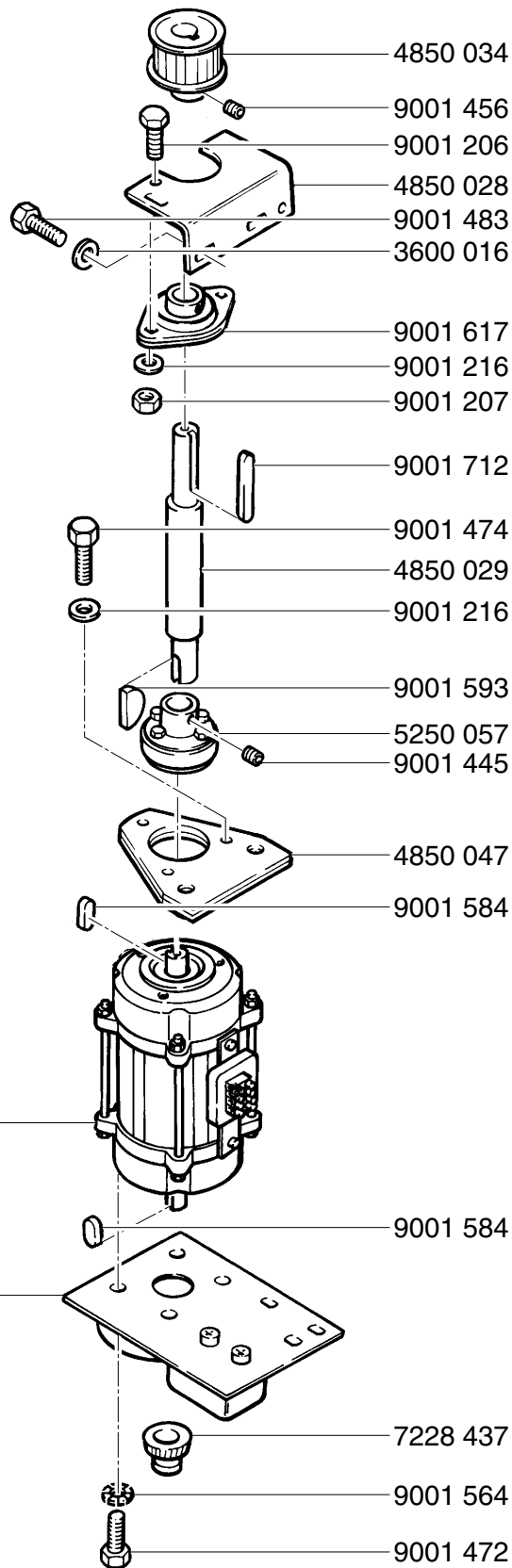

4850 034

9001 456

9001 206

4850 028

9001 483

3600 016

9001 617

9001 216

9001 207

9001 712

9001 474

4850 029

9001 216

9001 593

5250 057

9001 445

4850 047

9001 584

9001 584

7228 437

9001 564

9001 472

Mod.4850-95 D

01.08.2009

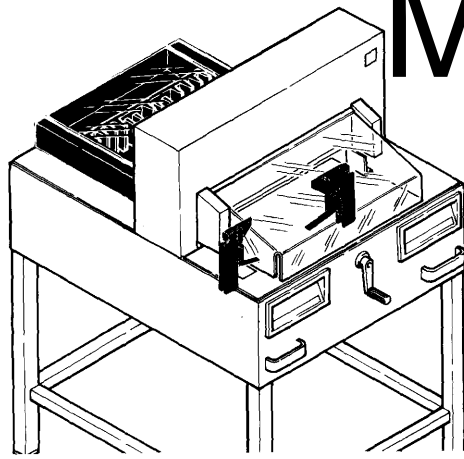

9001 913

4810 565

4850 625

4850 614

7228 468

4850 623

9001 614

9001 908

5250 065

9001 497

9001 562

5250 068

4810 496

9001 329

4810 527

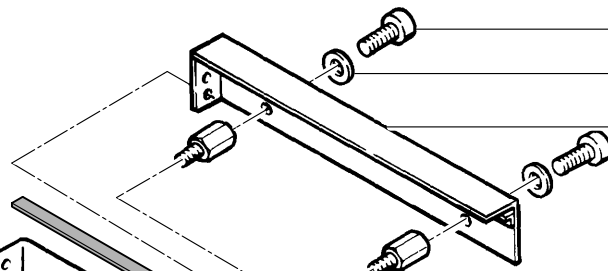

9001 908

9001 614

4850 622

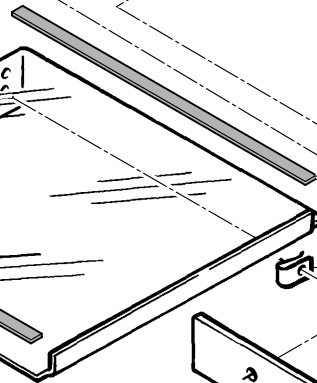

4810 565

9001 179

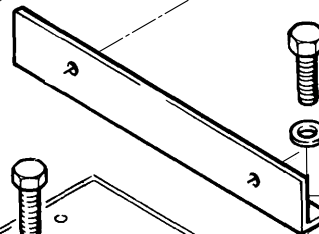

9001 483

3600 016

4850 615

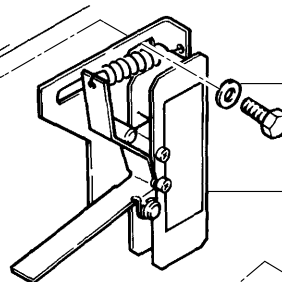
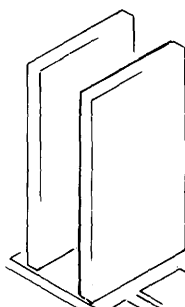
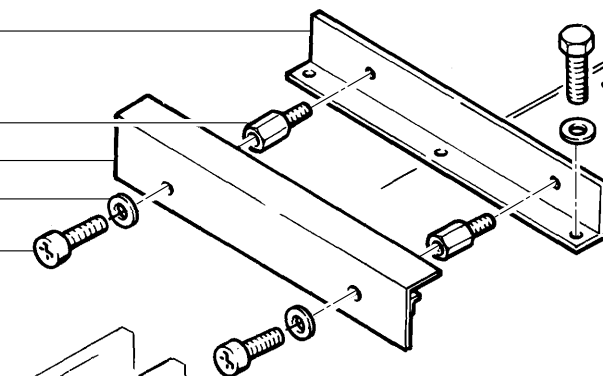

9001 216

9001 472

5250 064

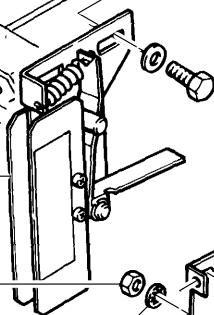

5250 067

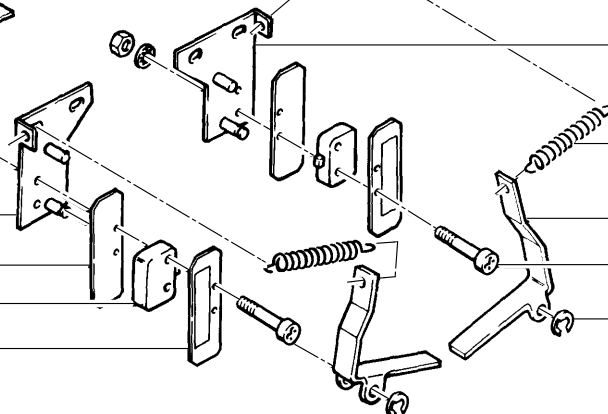

9001 137

5250 069

9003 488

9001 574

Mod.4850-95 D

01.08.2009

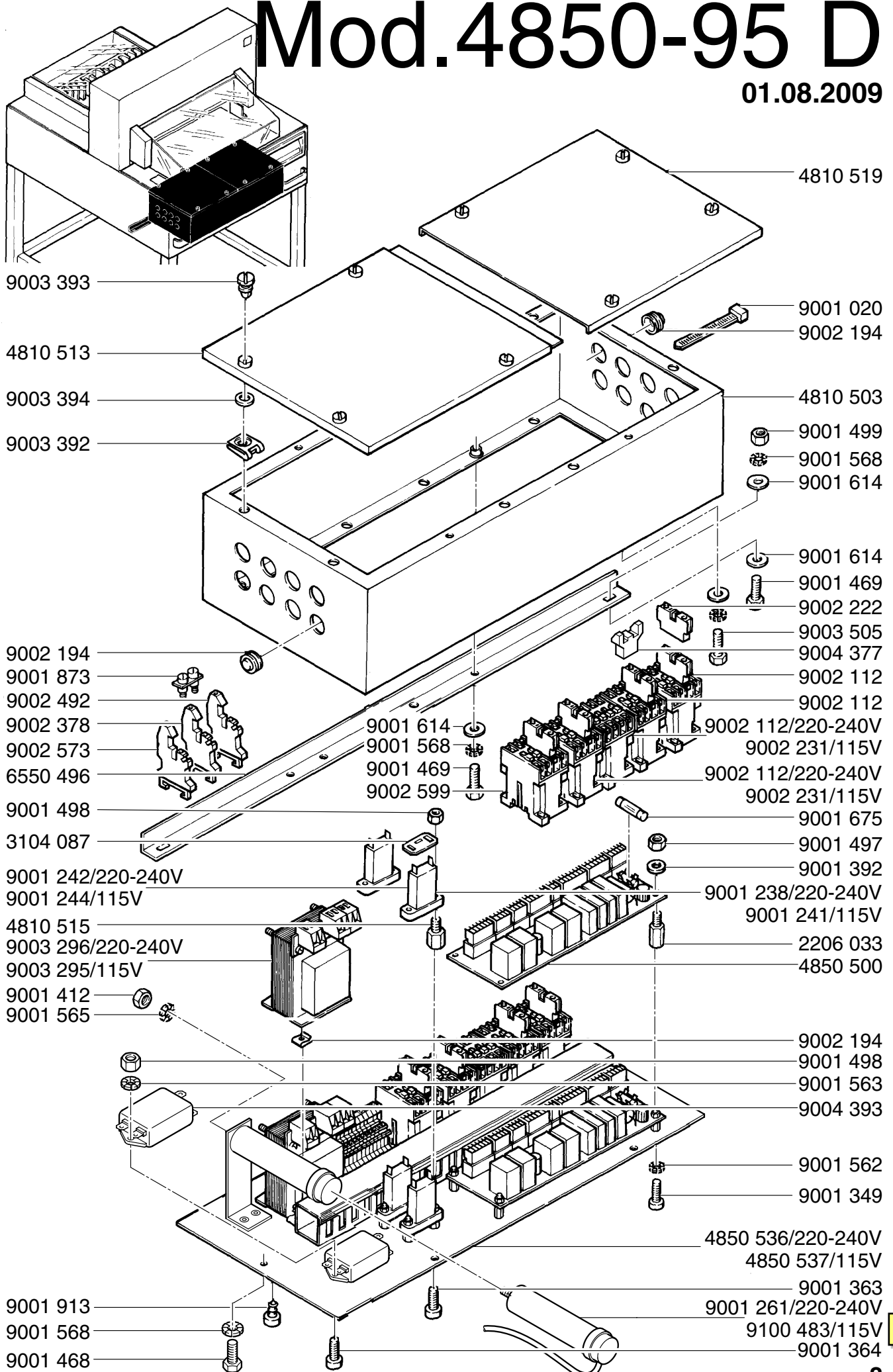

Mod.4850-95 D

01.08.2009

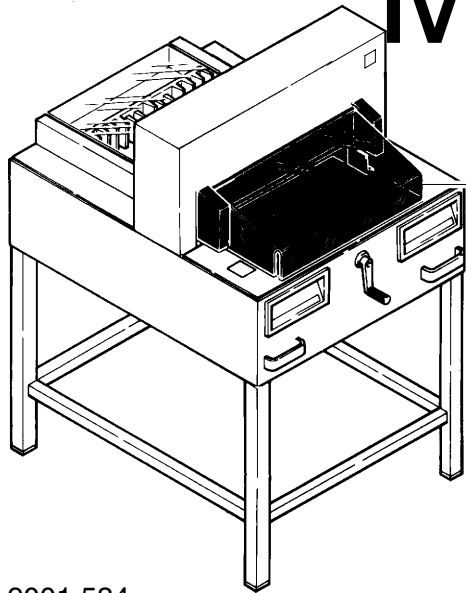

4810 499

9001 363
9001 563
9003 473

9003 094
9001 337
9001 563
4810 454
9001 563
9002 130

4810 459
9001 574

9003 510

9001 574
4810 455

9003 510
9003 354
9003 094

9001 563
4810 458

9001 563
9002 130

4810 482

9001 534

9001 556

9003 429

9001 556

4810 480

9001 646

9001 498

9001 646

4810 451

9001 869

9001 216

9001 564

9001 473

9001 473

9001 473

9001 473

9001 473

9001 473

9001 473

9001 473

9001 473

9001 473

9001 473

9001 473

9001 473

9001 473

9001 473

9001 473

9001 473

9001 473

9001 473

9001 473

9001 473

9001 473

9001 473

9001 473

9001 473

9001 473

9001 473

9001 473

9001 473

9001 473

9001 473

4810 570

4810 470

4810 449

9001 646

4810 470

9003 429

9001 556

9001 556

9001 534

9001 574

9003 434

9001 574

9003 094

9001 020

4810 487

9001 363

9001 646

4810 472

9001 869

9001 216

9001 564

9001 473

4810 475

9001 498

9002 130

9001 563

4810 458

9001 574

4810 457

9001 563

9003 354

9003 510

9003 473

9001 563

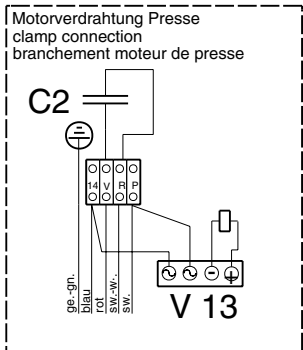
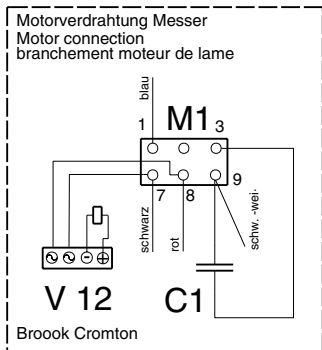
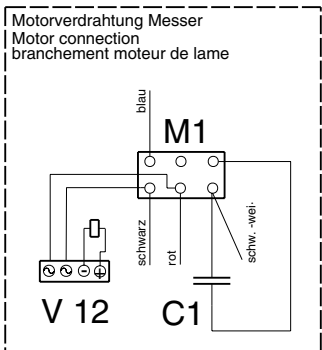
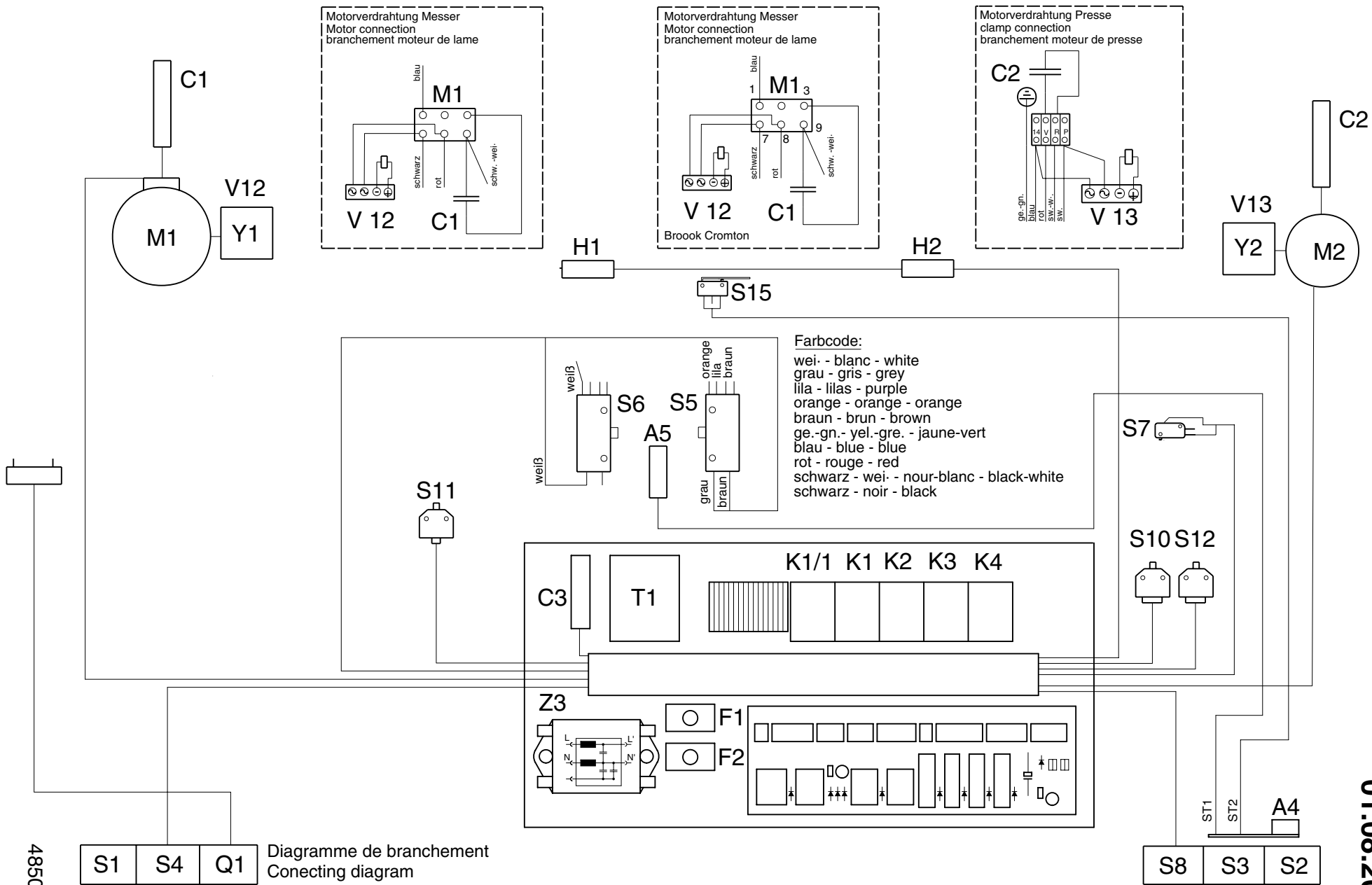

Farbcode:
 wei- - blanc - white
 grau - gris - grey
 lila - lilas - purple
 orange - orange - orange
 braun - brun - brown
 ge.-gn.- yel.-gre. - jaune-vert
 blau - blue - blue
 rot - rouge - red
 schwarz - wei- - noir-blanc - black-white
 schwarz - noir - black

S1 S4 Q1

Diagramme de branchement
 Conecting diagram
 Anschlußplan

4850 678
 10

Mod. 4850-95 D

01.08.2009

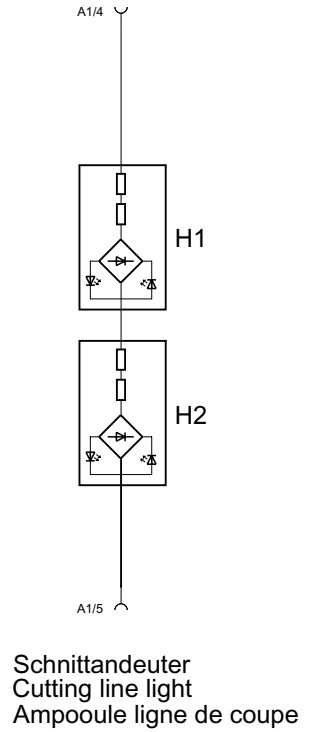
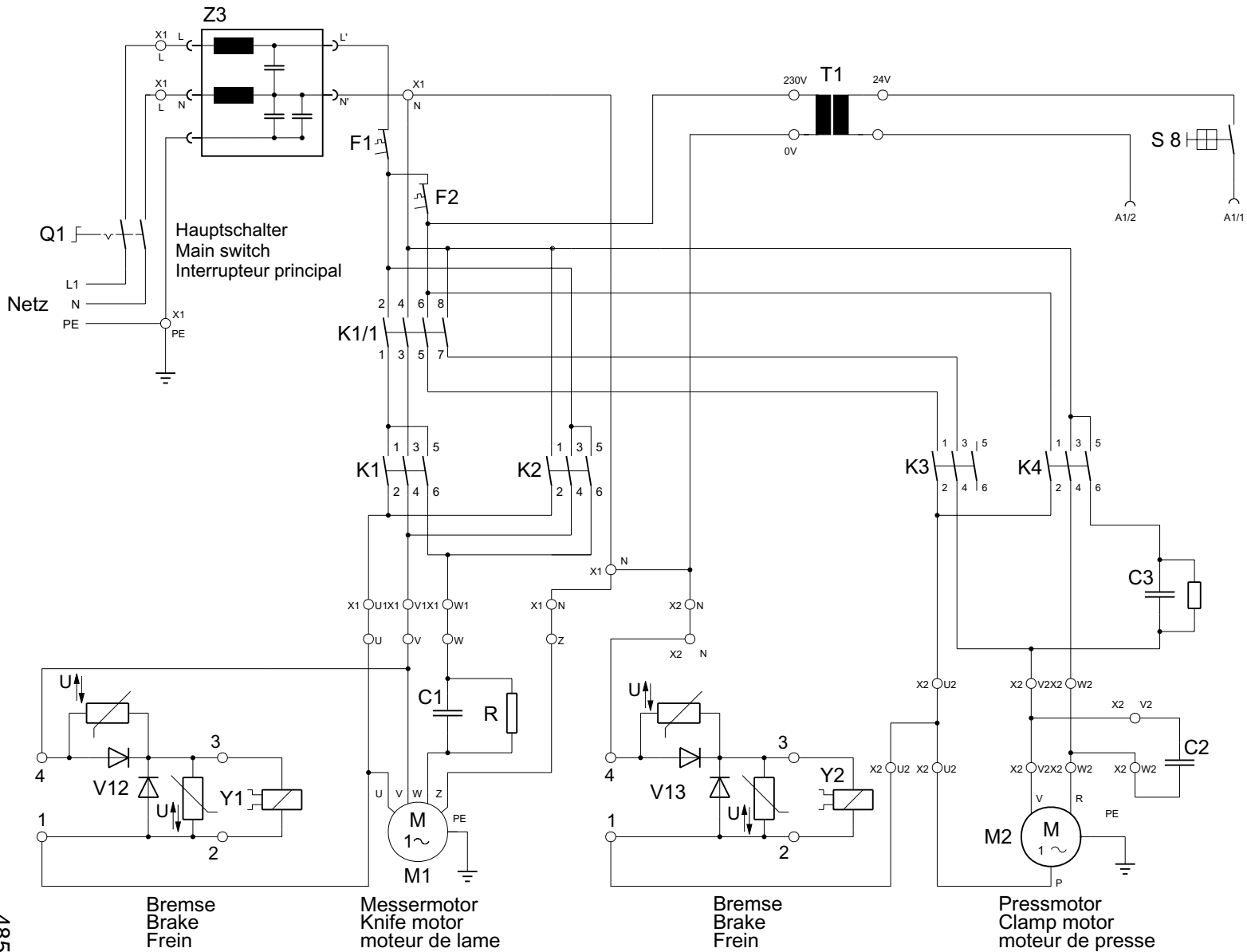

Mod. 4850-95 D

01.08.2009

Mod. 4850-95 D

01.08.2009

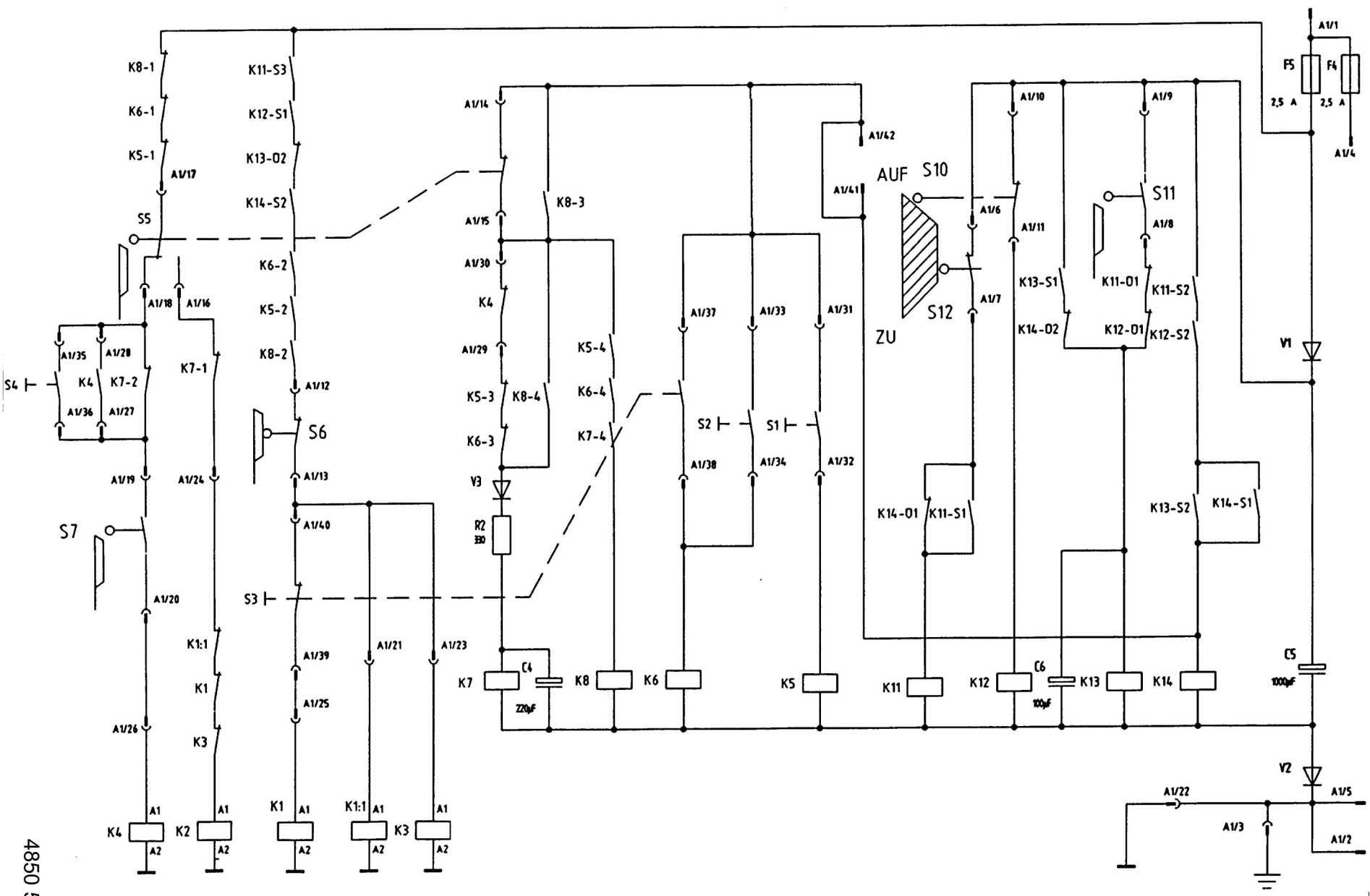

	Deutsch	English	Francais	Holländisch	Italiano	Espanol
A1	Platine Steuerung	PCB - control	Platine de commande	Stuurprint	Scheda controllo	Placa de control
A4	Platine Rückanschlag	PCB-backgauge	Platine butée arrière	Zadelmotorsturing	Scheda di battuta posteriore	Placa escuadra trasera
A5	Platine Geber	PCB-counter	Platine compteur d'impulsions	Print teller	Scheda contatore	Placa del contactor
C1	Kondensator	Capacitor	Condensateur	Condensator	Condensatore	Condensador
C2	Kondensator	Capacitor	Condensateur	Condensator	Condensatore	Condensador
C3	Kondensator	Capacitor	Condensateur	Condensator	Condensatore	Condensador
C4	Kondensator	Capacitor	Condensateur	Condensator	Condensatore	Condensador
C5	Kondensator	Capacitor	Condensateur	Condensator	Condensatore	Condensador
C6	Kondensator	Capacitor	Condensateur	Condensator	Condensatore	Condensador
F1	Überlastschutz Messer	Knife overload	Disjoncteur lame	Overbel. schakelaar mesm.	Interruttore sovraccarico lama	Disyuntor estribo cuchilla
F2	Überlastschutz Presse	clamp overload	Disjoncteur presse	Overbel. schakelaar persm.	Interruttore sovraccarico pressino	Disyuntor estribo prensa
F4	Sicherung	Fuse	Fusible	Zekering	Fusibile	Fusible
F5	Sicherung	Fuse	Fusible	Zekering	Fusibile	Fusible
H1	Schnittandeuter	Cutting line light	Ampoule ligne de coupe	Snijlijn-verlichting	Inticatore taglio	Luz línea de corte
H2	Schnittandeuter	Cutting line light	Ampoule ligne de coupe	Snijlijn-verlichting	Inticatore taglio	Luz línea de corte
K1	Schütz Messer ab	Knife-down contactor	Contact. descente de lame	Relais-mes omlaag	Relais-mes omlaag	Interruttore autom. discesa
K1/1	Schütz Messer ab	Knife-down contactor	Contact. desconte de lame	Relais-mes omlaag	Relais mes omlaag	Interruttore autom. discesa
K2	Schütz Messer auf	Knife-up contactor	Contact. remontée de lame	Relais-mes omlaag	Relais-mes omhoog	Interruttore autom. risalita

Index 4850-95, CE-48E

- 2 -

K3	Schütz Presse ab	Clamp-down contactor	Contact. descente presse	Relais pers omlaag	Interrutt. autom. discesa pressino	Contactora bajada prensa
K4	Schütz Presse auf	Clamp-up contactor	Contact. remontée presse	Relais pers onhoog	Interrutt. autom. risalita pressino	Contactora subida prensa
K5	Relais Taster links	Relay push button left	Relais touche gauche	Relais drukknop links	Relais pulsante sinistro	Relé botón izquierdo
K6	Relais Taster rechts	Relay push button right	Relais touche droite	Relais drukknop rechts	Relais pulsante destro	Relé botón derecho
K7	Relais Verzögerung	Time-delay relay	Relais retard	Vertragsrelais	Relais de ritardo	Relé de atraso
K8	Relais Schnittwiederholung	Relay Cutting repetition	Relais répétition de coupe	Relais-snijgangherhaling	Relais riperizione taglio	Relé repitición corte
K11	Sicherheitsrelais Klappe	Relay safety flap	Relais volet de sécurité	Veiligheidsrelaiskap	Relais coperchio sicurezza	Relé tapa de seguridad
K12	Sicherheitsrelais Klappe	Relay safety flap	Relais volet de sécurité	Veiligheidsrelaiskap	Relais coperchio sicurezza	Relé tapa de seguridad
K13	Sicherheitsrelais Klappe	Relay safety flap	Relais volet de sécurité	Veiligheidsrelaiskap	Relais coperchio sicurezza	Relé tapa de seguridad
K14	Sicherheitsrelais Klappe	Relay safety flap	Relais volet de sécurité	Veiligheidsrelaiskap	Relais coperchio sicurezza	Relé tapa de seguridad
M1	Antriebsmotor Messer	Cutting motor	Moteur lame	Snijmotor	Motore lama	Motor de corte
M2	Antriebsmotor Presse	Clamp motor	Moteur presse	Persbalkmotor	Motore pressino	Motor prensa
Q1	Hauptschalter	Main switch	Interrupteur principal	Hoofdschakelaar	Interruttore a chiave	Interruptor principal
R2	Widerstand	Resistor	Résistance	Weerstand	Resistenza	Resistencia
S1	Taster Messer + Presse	Push button knife	Touche de commande and clamp	Drukknop mes + persbalk lame + presse	Pulsante lama + pressino	Botón de la cuchilla + prensa
S2	Taster Messer + Presse	Push button knife	Touche de commande and clamp	drukknop mes + persbalk lame + presse	Pulsante lama + pressino	Botón de la cuchilla + prensa
S3	Taster Presse ab	Push button clamp down	Touche de comande	Drukknop persbalk omlaag	Pulsante discesa pressino descente presse	Botón bajada prensa
S4	Taster Presse auf	Push button clamp up	Touche de commande	Drukknop persbalk omhoog	Pulsante risalita pressino presse remontée	Botón subida prensa

Index 4850-95, CE-48E

- 3 -

S5	OT-Stopschalter Messer	Switch knife top	Arrêt lame haut	Schakelaar mes boven	Fermo lama alto	Detención cuchilla arriba
S6	UT-Stopschalter Messer	Switch knife bottom	Arrêt lame bas	Schakelaar mes beneden	Fermo lama basso	Detención cuchillaabajo
S7	OT-Stopschalter Presse	Switch clamp on top	Arrêt presse Haut	Schakelaar persbalk boven	Fermo pressino alto	Detención prensa arrib
S8	Schaltenschloß	Key switch	Contacteur á clé	Sleutelschakelaar	Interruttore a chiave	Llave del interruptor
S10	Sicherheitsschalter Klappe	Switch safety flap	Micro-contactvolet	Veiligheidsschakelaar kap	Interruttore coperchio sicurezza de sécurité	Interruptor tapa de seguridad
S11	Sicherheitsschalter Klappe	Switch safety flap	Micro-contact volet	Veiligheidsschakelaar kap	Interruttore coperchio sicurezza de sécurité	Interruptor tapa de seguridad
S12	Sicherheitsschalter Klappe	Switch safety flap	Micro-contact volet	Veiligheidsschakelaar kap	Interruttore coperchio sicurezza de sécurit	Interruptor tapa de seguridad
S15	Rückanschlag vorne/Stop	Switchg backgauge	Fin de course avant forward/stop	Schakelaar schakelpunt voor butée arière de sécurité	Interruttore anteriore	Interruptor marca frontal
T1	Transformator	Transformer	Transformateur	Transformator	Trafoformatore	Transformador
V1	Diode	Diode	Diode	Diode	Diodo	Diode
V2	Diode	Diode	Diode	Diode	Diodo	Diode
V3	Diode	Diode	Diode	Diode	Diodo	Diode
V12	Gleichrichter Bremse	Rectifier	Redresseur frein	Gelijkrichter-rem	Raddrizzatore	Rectificador
V13	Gleichrichter Bremse	Rectifier	Redresseur frein	Gelijkrichter-rem	Raddrizzatore	Rectificador
Y1	Bremse Messermotor	Brake, knife motor	Frein moteur de lame	Rem-snijmotor	Freno motore lama	Freno motor cuchilla
Y2	Bremse Pressmotor	Brake, clamp motor	Frein moteur de presse	Rem-persmotor	Freno motore pressino	Freno motor prensa
Z3	Entstörfilter	RC - filter	Filtre RC	Onstoorfilter	Filtro-antidisturbo	Filtro RC suppressor

Mod. 4850-95 D

01.08.2009

Mod.4850-95 D

01.08.2009

